

Courses & Distances
 Beg. 9 Gum
 North 47 to Spanish
 Oak Hence down
 Penns Creek
 323 Perches to
 An Ash.
 South 9 to Sugar
 Tree
 S 72 W 120 white
 Oak
 South 20 Pine
 S. 77 W 200 Post
 North 28 Swamp
 white Oak
 N. 45 E 20
 to the Beg. 9.

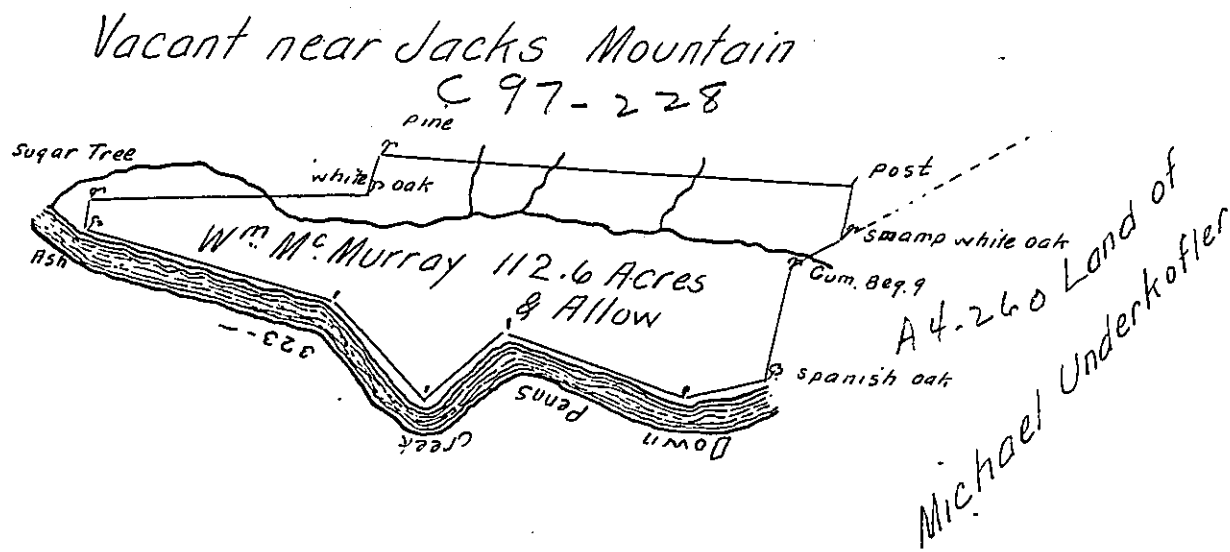

The Above Draught is copied from an Old Draught which was formerly deliv-
 ered for the Use of the party I am satisfyed That the Survey was made
 under my direction while I acted As Deputy Surveyor, and I have no
 doubt of its having been returned. I can only give the Distance Down
 the Creek. The Courses not having been inserted in the Rough Drau-
 ght. The Warrant appears to have been dated the 30th of October
 A. Dom. 1772.

To Daniel Brodhead Esqr. } W^m Maclay-
 Surv^r Gen^l of Pennsyla }

N.B. The Above Land is in Buffalo Township, Northumberland County

IN TESTIMONY that the above is a copy of the original remaining on file in
 the Department of Internal Affairs of Pennsylvania, made
 conformably to an Act of Assembly approved the 16th day of
 February, 1833, I have hereunto set my Hand and caused
 the Seal of said Department to be affixed at Harrisburg,
 this thirteenth day of November 1905,

Isaac N. Brown
 Secretary of Internal Affairs.